

Center Pin Drive Anchors

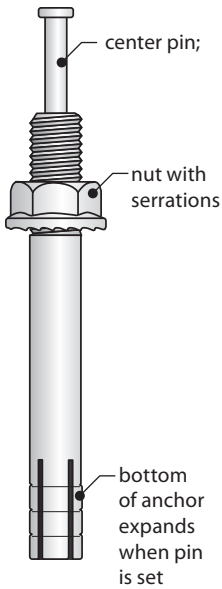

Hammer in to create tension then tighten nut to secure

Key Features/Benefits

- Easy to install
 - Just hammer the center pin and it's set
 - Anchor tensions itself automatically, so no wrench is needed
- Easy to inspect
 - Anchor is set when center pin is flush with top of hole
- Depth of hole not critical
 - No depth gauge required
- Actual diameter of the anchor is the same as its nominal diameter
 - No templates required
- Serrations on nut provide vibration resistance
- Yellow dichromate finish provides superior corrosion resistance

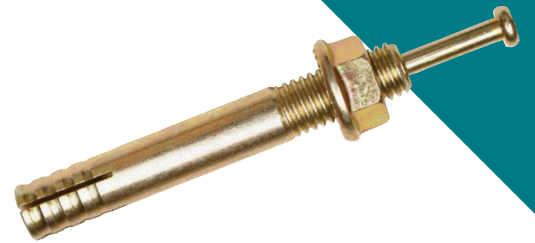

Specifications, Listings and Approvals

Diameters: 1/4" – 3/4"

Materials:

- **Anchor Body:** Hot Rolled Steel
- **Pin:** Hot Wrought Iron

Finish: Yellow Dichromate Coating

Federal Specifications:

- QQZ-325Z, Type II Class 3 (yellow dichromate added)
- GSA FFS-325 Group II Type 4 Class I

Order Information

Catalog Number	Anchor Size (in.)	Max. Thickness Fastened (in.)	Minimum Embedment (in.)	Box Qty.	Case Qty.
CP1413	1/4 x 1-3/4	3/8	1-1/8	100	800
CP1423	1/4 x 2-3/8	1	1-1/8	100	800
CP5620	5/16 x 2	5/16	1-3/8	100	800
CP5623	5/16 x 2-3/4	11/16	1-3/4	100	800
CP3823	3/8 x 2-3/8	5/8	1-3/8	50	400
CP3832	3/8 x 3-1/2	1-3/8	1-3/4	50	400
CP3843	3/8 x 4-3/4	2-5/8	1-3/4	50	400
CP1223	1/2 x 2-3/4	1/4	2	25	200
CP1232	1/2 x 3-1/2	3/4	2-1/4	25	200
CP1243	1/2 x 4-3/4	2	2-1/4	25	200
CP1260	1/2 x 6	3-1/4	2-1/4	25	200
CP5840	5/8 x 4	1-5/8	2-3/4	10	80
CP5860	5/8 x 6	2	2-3/4	10	80
CP3450	3/4 x 5	2	3-1/2	10	30
CP3460	3/4 x 6	2	3-1/2	10	30
CP3472	3/4 x 7-1/2	2	3-1/2	10	30

Maximum Tensile and Shear Capacity For Static Loads

Anchor Dia. (in.)	Embedment Depth (in.)	2000 psi		4000 psi	
		Tension (lb.)	Shear (lb.)	Tension (lb.)	Shear (lb.)
1/4	1-1/8	780	1000	1567	1000
5/16	1-1/2	2130	1320	3159	1320
3/8	1-7/8	2530	2580	3307	3580
1/2	2-1/2	4040	4920	5604	4920
5/8	2-3/4	6360	9200	7742	9200
3/4	3-1/2	8700	11400	12083	11400

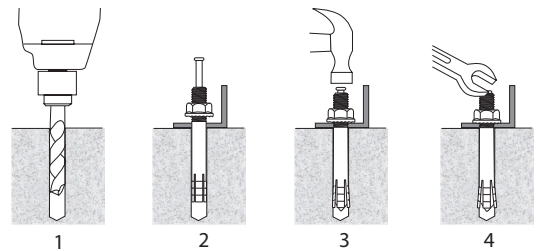

Installation Instructions

1. Drill the hole perpendicular to the work surface. To assure full holding power, do not ream the hole or allow drill to wobble. Clean hole using compressed air and a nylon brush. A clean hole is necessary for proper performance.
2. Preset the nut and washer for desired embedment.
3. Hammer center pin until it is aligned with the top of the bolt.
4. Tighten nut.

NOTE: Always wear safety glasses. Follow drill manufacturer's instructions. Use only solid carbide-tipped drill bits meeting ANSI B212.15 diameter standards.

Edge Distance Requirements

Embedment (E) in Anchor Diameters	Spacing	Edge Distance
E < 6d (shallow)	3.5E	1.75E
6d ≤ E ≤ 8d (standard)	2.00E	1.00E
8d < E (deep)	1.50E	0.75E